

MARK	DATE	REVISION	REVISER	APP. BY
①				
②				
③				

MODEL NO			SESAL			
MATERIAL			HOUSING-AL			
			LENS-TEMPERED CLASS			
			REFLECTOR-HEAT RESISTANT ABS			
COLOR OF LENS.			RED(    ), AMBER(    ), GREEN(    ), BLUE(    )			
FLASHING PER MIN.			60 ~ 80			
USE VOLT.	LED	CURRENT	DC12V	0.08W	MAX. 2.511A	
			DC24V		MAX. 1.222A	
			AC120V		MAX. 0.286A	
			AC230V		MAX. 0.143A	
VOLUME			MAX. 118dB			
PROTECTION GRADE			WATER & DUST PROOF IP66			
CABLE ENTRY			1/2" NPT			
COLOR OF HOUSING			MUNSELL NO. 7.5BG 7/2			
ACTION			LED STEADY/ FLASHING LIGHT			

※ Voltage AC120V: AC110V-120V, AC230V: AC220V-230V

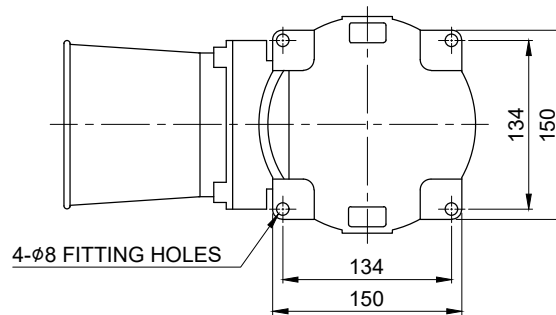

ISO2768-1 : CLASS OF TOLERANCE						SURFACE FINISH		-	-	-	-	1	-
FOR LINEAR DIMENSIONS	0.5~3	±0.05	±0.1	±0.2	-			Nr.	DWG. NO.	TITLE/ NAME	MAT'L	QTY	REFERENCE
	3~6	±0.05	±0.1	±0.3	±0.5			DSND BY	CHKD BY	CHKD BY	APRV BY	VIEW	DATE
	6~30	±0.1	±0.2	±0.5	±1			S.H.KIM	J.H.PARK	J.K.HAN	J.K.HAN	3	2016.08.30
	30~120	±0.15	±0.3	±0.8	±1.5			TITLE			MODEL		
	120~400	±0.2	±0.5	±1.2	±2.5			SESAL OUTLINE DRAWING			SESAL		
	400~1000	±0.3	±0.8	±2	±4			Qlight			DWG. NO. SESAL_OUT		
FOR ANGULAR DIMENSIONS	0~10	±1°	±1°30'	±3°				SCALE		SIZE		REV	SHEET
	10~50	±0°30'	±1°	±2°				N/S		A4		00	1/1
	50~120	±0°20'	±0°30'	±1°									
	120~400	±0°10'	±0°13'	±0°30'									

A4(297X210)