

EMCL Series



EMCL30

EMCL50

PRODUCT SPECIFICATION

EMCL30 | EMCL50
EMCL70 | EMCL90

Materials Housing-Al, Lens-PC

Ambient operating temperature -25°C to +55°C

Volume Max. 85dB at 1m

Protection rating

Standard type-IP69K, Built-in buzzer type-IP20

- Small indicator light capable of transmitting three signal colors with one indicator light
- By applying a milky translucent lens, the unique color of the LED is emitted subtly when turned on
- Respond to customer needs with various outer diameters (30mm, 50mm, 70mm, 90mm) and designs
- Waterproof and dustproof model with fully sealed structure with IP69K degree of protection to cope with harsh environmental conditions
- Buzzer specifications can be selected for signal wire withdrawal type or M12 connector mounting type



EMCL Series Industrial LED beacon

Model number	Voltage	Current	Certificates	Weight	Color		
EMCL30 Steady	DC24V	40mA		0.05kg	<div><div><div></div></div>R-Red</div> <div><div></div></div> A-Amber		
EMCL30-BZ Steady w/built-in buzzer							
EMCL50 Steady				0.09kg			
EMCL50-BZ Steady w/built-in buzzer							
EMCL70 Steady		61mA		0.16kg			
EMCL70-BZ Steady w/built-in buzzer							
EMCL90 Steady				0.21kg			
EMCL50-EMCL90-BZ Steady w/built-in buzzer							

Bracket

- It can be installed on the wall by adopting wall mounting type bracket.



Φ23.5 type



Φ32 type

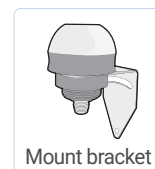

Mount bracket

Wiring Instructions

• EMCL Series

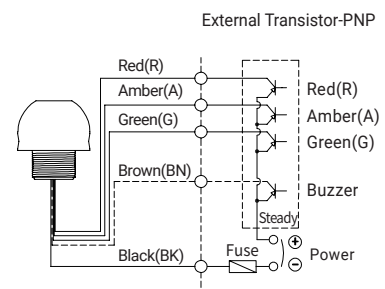
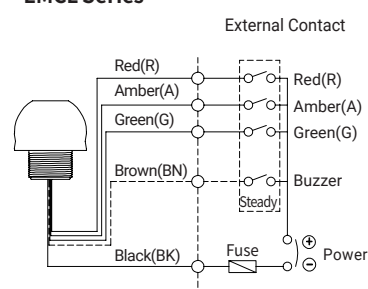

Technical Diagram

Units: mm

• EMCL30 / EMCL30-BZ

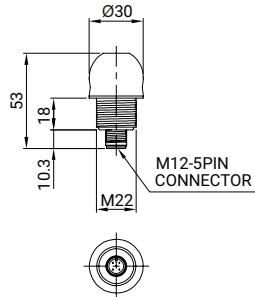

• EMCL50 / EMCL50-BZ

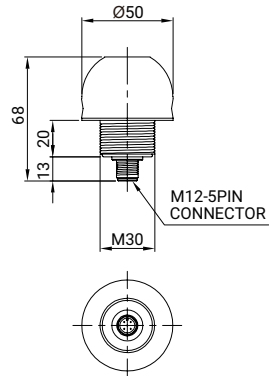

• EMCL70 / EMCL70-BZ

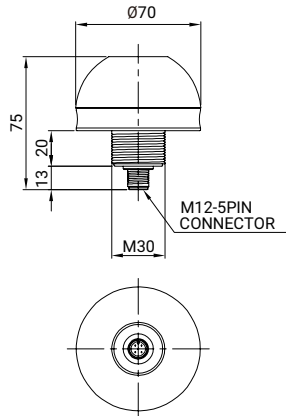

• EMCL90 / EMCL90-BZ

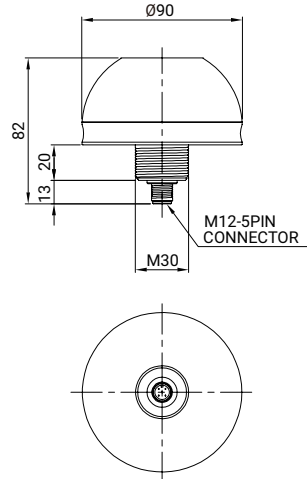

EMCL70

EMCL90

Customization

- M12 Five- Core Cable/1.5m
- NPN type

M12 connector type

5PIN CONNECTOR	No.	Color	Wiring
	1	RED	Pin 1
	2	AMBER	Pin 2
	3	GREEN	Pin 3
	4	Common	Pin 4
	5	Buzzer	Pin 5

Ordering Specification

EMCL30	-	24	-	RAG	-	M12
[Model number]		[Voltage]		[Color]		[Cable]
EMCL30		24-DC24V		● R-Red		None-External contact
EMCL30-BZ				● A-Amber		M12-M12 connector type
EMCL50				● G-Green		
EMCL50-BZ						
EMCL70						
EMCL70-BZ						
EMCL90						
EMCL90-BZ						