



SSEL

PRODUCT SPECIFICATION

SSEL

Materials Lens-Tempered glass, Housing-Al**Ambient operating temperature** $-40^{\circ}\text{C} \leq T_{\text{amb}} \leq +60^{\circ}\text{C}$ **Explosion protection rating** Ex d IIC T6, IP66**Certificates** KIMM**Housing standard color** MUNSELL No. 7.5BG 7/2**Cable entry** 1/2" NPT

- Suitable for helideck and other dangerous areas that require a perimeter light
- Structure minimizing the projection of lens, can be protected from damage by external impact
- Product structure with 100mm height meets the IMD regulation condition
- Aluminum housing provides excellent durability
- Terminal for power wiring located inside of the housing

SSEL Explosion Proof LED Perimeter Light

Model number	Voltage	Current	Certificates	Weight	Color
SSEL	DC12V	0.460A		2.54kg	● R-Red ● A-Amber ● G-Green ● B-Blue
	DC24V	0.255A		2.54kg	
	AC110V	0.040A		2.54kg	
	AC220V	0.040A		2.54kg	

Technical Diagram

·SSEL

Units: mm

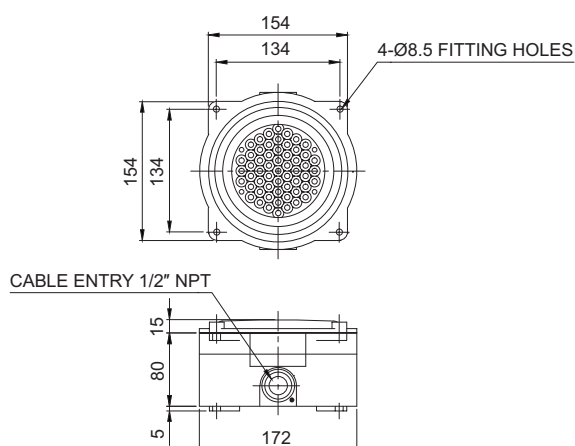

Customization

- Explosion proof cable gland attached type available (Standard type does not come with explosion proof cable gland)
- 2 ways cable entries
- Customized cable entry(3/4" NPT, M20×1.5, M25×1.5) available

Ordering Specification

SSEL	-	220	-	R
[Model number]		[Voltage]		[Color]
SSEL		12-DC12V 24-DC24V 110-AC110V 220-AC220V		● R-Red ● A-Amber ● G-Green ● B-Blue