

QAP Series

Wall mount multifunctional electric horn which supports 30 built-in sounds and 30 user defined sounds(MP3)



- **QAP100H / QAP125H(MP3)**
 - User defined 30 sounds, 30 built-in sounds
- **QAP100H-N / QAP125H-N (standard unit)**
 - 30 built-in sounds

PRODUCT SPECIFICATION

QAP80H | QAP100H | QAP125H
QAP100H-N | QAP125H-N

Materials Housing-ABS, Resonance chamber-ABS

Ambient operating temperature -25°C to +50°C

Protection rating IP65

Compliant with RoHS directive

- Signal sound diffusing structure with wall mount supports 30 Built-in sounds and 30 user defined sounds
- Volume control and tone selector switches are installed inside the unit (Buzzer type is unsupported)
- User has the ability to enter voice tones directly into the unit via MP3 files from the SD card
- This product has 30 Built-in sounds via binary input mode or bit input mode
- Binary input mode allows the user to select from 30 different sound options with the tone selection switch
- Bit input mode is organized into 6 groups of 5 sound tones for a total of 30 sound tone options. Playback can be selected from one of the 5 tones in each group (MP3 file with bit input mode)
- Supports both SD card and MP3(QAP100H/QAP125H)
- Standard unit choose built-in sound only. It can choose 30 sounds in accordance with the customer's needs.

Function setting for multifunctional product

- Standard unit does not support either SD card or Play mode.

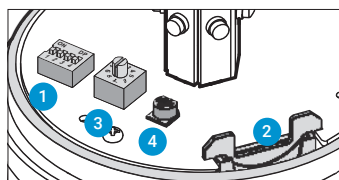

- 1 Sound setup switch
- 2 SD Card for MP3 play
- 3 Play mode set up switch
- 4 Volume

Sound Selection Instruction for SDCard Type

- SD card type unit
- It can choose both built-in sounds and user defined sounds(MP3) by controlling sound setup switch no. 1.
- Standard unit
- It can choose both Bit input mode and Binary input mode by controlling sound setup switch no. 1.

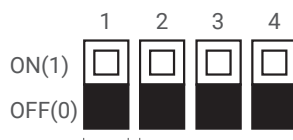

Sound Selection

- 0: Built-in sound
- 1: SD Card(MP3)

Standard unit(Built-in sound only)

- 0:Bit input(Can choose 5 channels per group)
- 1:Binary(Can choose 30 channels)

Bit input mode selection from 6 groups

- 001: WS(5 Warning sounds)
- 010: WP(5 Special warning sounds 1st group)
- 011: WM(5 Melodies)
- 100: WA(5 Alarms)
- 101: WO(5 Special warning sounds 2nd group)
- 110: WN(5 Special warning sounds 3rd group)

- 30 pre-recorded sounds offered(5 warning sounds, 5 special warning sounds 1st group, 5 melodies, 5 alarms, 5 special warning sounds 2nd group, 5 special warning sounds 3rd group)
- External MP3 sound support(SD card)
- Binary input: 30 channels
- Bit input: 5 channels(6 sound groups)
- A multi-functional product that can use an SD card for MP3 playback
- Please refer to [Sound pattern and combination for multifunctional product] on this catalogue for channel input setting.

Features per modelst

	QAP100H / QAP125H(MP3)	QAP80H / QAP100H-N QAP125H-N(standard unit)	Column
Support SD card(MP3)	O	X	
Support 30 built-in sounds	O	O	
Play mode	O	X	
Bit/Binary input	O	O	Please refer to sound setup switch manual parts



QAP100H-N Electric Horn, Wall Mount Type

Model number	Voltage	Current	Sound pattern and volume	Certificates	Weight
QAP100H-N	DC12V-24V	Max.0.850A	· Bit Input: 5Ch · Binary Input: 30Ch · Built-in volume : Max.100dB	CE	0.60kg
	AC110-220V	Max.0.175A	(Based on WA-Ch4)		0.63kg

※ DC type model has a free-voltage range of 10V-30V.

※ AC type model has a free-voltage range of 100V-240V.



QAP100H / QAP100H-N

QAP125H-N Electric Horn, Wall Mount Type

Model number	Voltage	Current	Sound pattern and volume	Certificates	Weight
QAP125H-N	DC12V-24V	Max.1.000A	· Bit Input: 5Ch · Binary Input: 30Ch · Built-in volume : Max.115dB	CE	0.70kg
	AC110-220V	Max.0.190A	(Based on WA-Ch4)		0.73kg

※ DC type model has a free-voltage range of 10V-30V.

※ AC type model has a free-voltage range of 100V-240V.

Ordering Specification

QAP100H-N	-	12/24
[Model number] QAP100H-N QAP125H-N		[Voltage] 12/24-DC12V-24V 110/220-AC110V-220V

QAP Series

Technical Diagram

Units: mm

·QAP80H

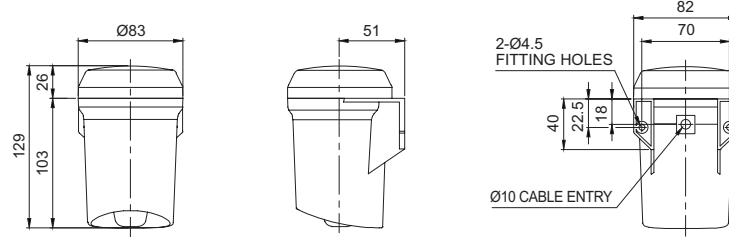

·QAP100H / QAP100H-N

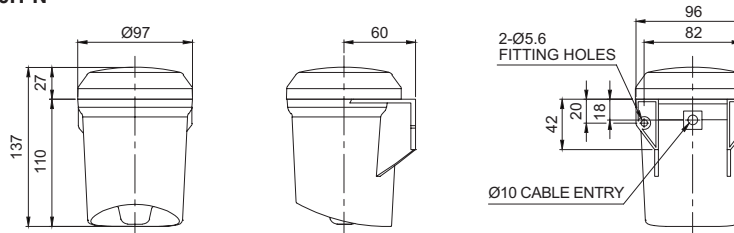

·QAP125H / QAP125H-N

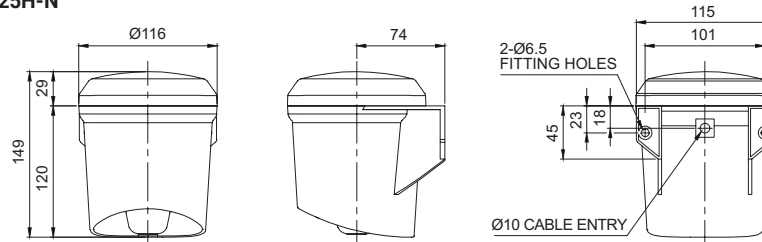

Wiring Instructions

·QAP80H-DC / QAP100H-DC/AC ·QAP100H-N-DC/AC

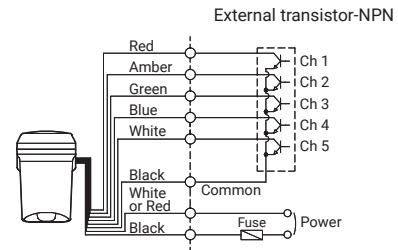
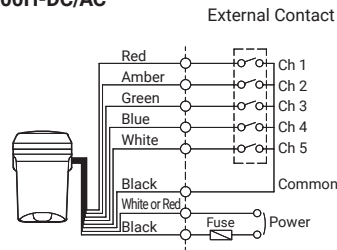

·QAP125H-DC/AC ·QAP125H-N-DC/AC

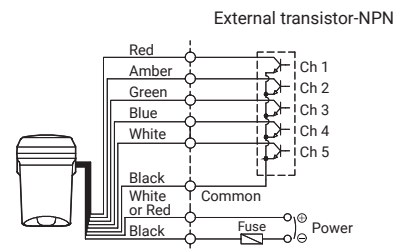
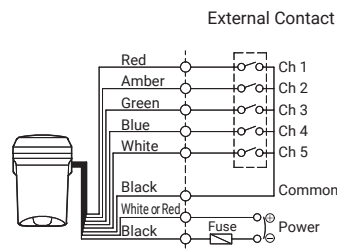

- External Power line - UL1015 AWG18(0.75sq) x 2C 400mm
- External signal line - UL1007 AWG22(0.3sq) 400mm
- QAP80H / QAP100H - This product can be wired regardless of polarity.
- QAP125H - Black output line is negative(-).
- In case of Bit input, 5 sound tones can be played. For Binary input, 30 sound tones can be played.
- ※ Please refer to [Sound pattern and combination for multifunctional product] on this catalogue for channel input setting(Wiring instruction is replaced to channel selection switch)