

# S60 Series



S60R



S60LR



S60L

## PRODUCT SPECIFICATION

S60R | S60LR | S60L

**Materials** Lens-AS, Housing-ABS,  
Reflector-Heat resistant ABS  
**Ambient operating temperature** -20°C to +50°C  
**Protection rating** IP44

- Ø60mm compact warning/signal lights

### S60R Bulb Revolving Warning Light

Model number	Voltage	Current	Bulb			Certificates	Weight	Color
			Spec	Standard	Parts no			
S60R	DC12V	0.484A	12V5W	T16x35 15S	5	CE	0.18kg	● R-Red
	DC24V	0.340A	24V5W	T16x35 15S	6		0.18kg	● A-Amber
	AC110V	0.080A	120V5W	T16x35 15D	7		0.27kg	● G-Green
	AC220V	0.036A	240V5W	T16x35 15D	8		0.27kg	● B-Blue

· Revolving speed: 120-140RPM

※ CE compliant: DC12V, DC24V

### S60LR LED Revolving Warning Light

Model number	Voltage	Current	Certificates	Weight	Color
S60LR	DC12V	0.183A	-	0.21kg	● R-Red
	DC24V	0.127A		0.21kg	● A-Amber
	AC110V	0.045A		0.28kg	● G-Green
	AC220V	0.020A		0.28kg	● B-Blue

· Revolving speed: 120-140RPM

### S60L LED Steady/Flashing Signal Light

Model number	Voltage	Current	Certificates	Weight	Color
S60L	DC12V-24V	Max.0.120A	-	0.15kg	● R-Red
	AC110V	0.045A		0.20kg	● A-Amber
	AC220V	0.020A		0.20kg	● B-Blue

· Flashing rate: 60-80 flashes/min

※ DC type model has a free-voltage range of 10V-30V

### Technical Diagram

Units: mm

·S60R / S60LR

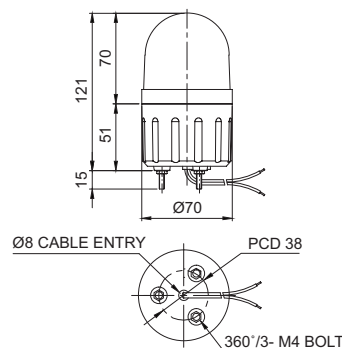

·S60L

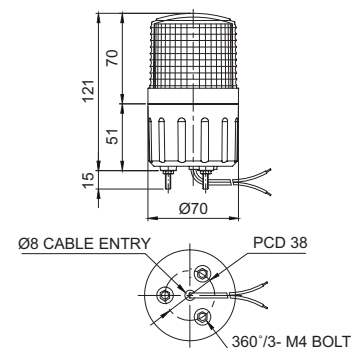

### Wiring Instructions

- External Power line  
UL1015 AWG18(0.75sq) x 2C 400mm
- DC type for S60R/S60LR  
: Black output line is negative(-)
- S60L model can be wired regardless of polarity.

### Customization

- Wall mount bracket options  
: Bracket structure allows for threading through the bracket hole or into the wall mount.



Wall Mount Bracket  
TWS45



Wall Mount Bracket  
TWA45

### Ordering Specification

<b>S60R</b>	-	<b>24</b>	-	<b>R</b>
[Model number]		[Voltage]		[Color]
S60R		12-DC12V		● R-Red
S60LR		24-DC24V		● A-Amber
S60L		12/24-DC12V-24V(S60L only)		● G-Green
		110-AC110V		● B-Blue
		220-AC220V		