

Multiple Function LED Signal Lights

MFL Series

Operating steady/flashing, strobe, simulated revolving flashing, Multiple function LED signal lights



MFL60

PRODUCT SPECIFICATION

MFL60 | MFL80
MFL100 | MFL125

Materials Lens-PC, Housing-ABS

Ambient operating temperature -30°C to +50°C

Volume Max.80dB at 1m

Protection rating IP65

Simulated revolving type(LR) flashing rates 120-140RPM

Flashing type(LF) flashing rates 60-80/min

Strobe type(LS) flashing rates 70-80/min

Compliant with RoHS directive

- Product has multi functions of LED Steady/Flashing, strobe, and simulated revolving
- Operating options with switches inside product or external connect
- Shock and vibration-resistant, maintenance reduced with long-lasting energy-efficient LED light bulb
- Can select between standard and built-in buzzer type depending on installation environment
- M12 connector type is optionally available(Female M12 connector is not provided)

Manual switch to select operation

ON=1/OFF=0 Operate 4 kinds of function by dip switches

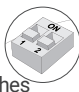

| No. | 1 | 2 | Operation |
|-----|---|---|----------------------------------|
| 0 | 0 | 0 | LED Steady |
| 1 | 0 | 1 | LED flashing |
| 2 | 1 | 0 | LED Strobe |
| 3 | 1 | 1 | LED Simulated revolving flashing |

Operation

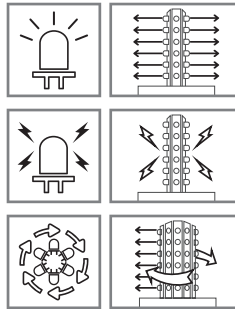

• LED Steady/Flashing

Repeat operation of LED signal light on/off

• LED Strobe

Short LED Steady/ Flashing cycle. Creates a xenon flashing effect by providing maximum electric current

• LED Simulated Revolving

LEDs flash steadily around the cylindrical LED filaments which makes a simulated revolving effect

MFL60 Ø60mm Multiple Function LED Signal Lights

| Model number | Voltage | Current | Certificates | Weight | Color |
|--------------|-------------|------------|--------------|--------|---|
| MFL60 | DC12V-24V | Max.0.118A | CE | 0.21kg | <div></div> <div></div> <div></div> <div></div> |
| | AC110V-220V | Max.0.060A | UL | 0.32kg | <div></div> <div></div> <div></div> <div></div> |

※ UL Listed: DC12V-24V

MFL80 Ø80mm Multiple Function LED Signal Lights

| Model number | Voltage | Current | Certificates | Weight | Color |
|--------------|-------------|------------|--------------|--------|---|
| MFL80 | DC12V-24V | Max.0.118A | CE | 0.28kg | <div></div> <div></div> <div></div> <div></div> |
| | AC110V-220V | Max.0.075A | UL | 0.51kg | <div></div> <div></div> <div></div> <div></div> |

※ UL Listed: DC12V-24V

MFL100 Ø100mm Multiple Function LED Signal Lights

| Model number | Voltage | Current | Certificates | Weight | Color |
|--------------|-------------|------------|--------------|--------|---|
| MFL100 | DC12V-24V | Max.0.118A | CE | 0.30kg | <div></div> <div></div> <div></div> <div></div> |
| | AC110V-220V | Max.0.090A | UL | 0.52kg | <div></div> <div></div> <div></div> <div></div> |

※ UL Listed: DC12V-24V

MFL125 Ø125mm Multiple Function LED Signal Lights

| Model number | Voltage | Current | Certificates | Weight | Color |
|--------------|-------------|------------|--------------|--------|---|
| MFL125 | DC12V-24V | Max.0.118A | CE | 0.52kg | <div></div> <div></div> <div></div> <div></div> |
| | AC110V-220V | Max.0.090A | UL | 0.92kg | <div></div> <div></div> <div></div> <div></div> |

※ DC type model has a free-voltage range of 10V-30V.

※ AC type model has a free-voltage range of 100V-240V.

※ UL Listed: DC12V-24V

Wiring Instructions

- External Power line
- UL1015 AWG18(0.75sq) x 2C 400mm
- This product can be wired regardless of polarity.

Technical Diagram

Units: mm

·MFL60

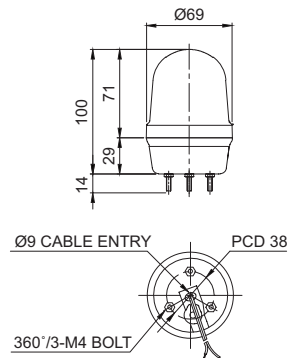

·MFL80

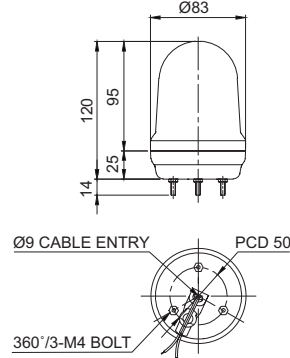

·MFL100

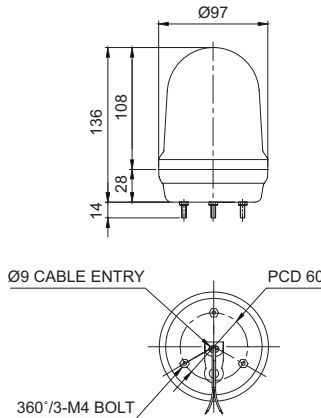

·MFL125

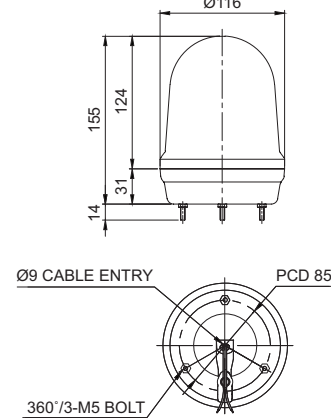

MFL80



MFL100



MFL125

Customization

- Wall mount bracket options: Bracket structure allows for threading through the bracket hole or into the wall mount

| MFL60 | | MFL80 | | MFL100 / MFL125 | |
|-----------------------------|-----------------------------|-----------------------------|-----------------------------|------------------------------|------------------------------|
| | | | | | |
| Wall Mount Bracket TWS45 | Wall Mount Bracket TWA45 | Wall Mount Bracket TWS80 | Wall Mount Bracket TWA80 | Wall Mount Bracket SWP125 | Wall Mount Bracket SWM125 |

- Wall-mounted type/Pole-mounted type: For detailed mounting information, please refer to the Q Series in this catalog.

Wiring Instructions

- External Power line - UL1015 AWG18(0.75sq) x 2C 400mm
- This product can be wired regardless of polarity.

Ordering Specification

| MFL100 | - | BZ | - | 110/220 | - | R |
|------------------------------------|---|--|---|--|---|--|
| [Model number] | | [Buzzer option] | | [Voltage] | | [Color] |
| MFL60 MFL80 MFL100 MFL125 | | (None) - No buzzer BZ - Built-in buzzer | | 12/24-DC12V-24V 110/220-AC110V-220V | | <div>R-Red</div> <div>A-Amber</div> <div>G-Green</div> <div>B-Blue</div> |