

Wall Mount LED Signal Tower with Built-in Audible Alarm

QWTD

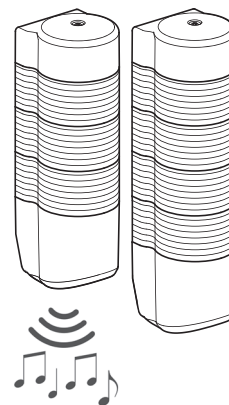

Thank you for purchasing Qlight's products. Please read this user manual carefully prior to installation and operation to ensure safe and correct use.

⚠ Precautions for Safety

Failure to follow the instructions below may cause a loss of life or serious physical injury.

1. During wiring or maintenance, please completely turn off the power of the product. (Failure to follow this may lead to an electric shock.)
2. Do not install the product in locations that subjects it to excessive dust or water other than the conditions designated by the IP protection ratings indicated for each product. (Failure to follow these instructions may cause a fire to the product, electric shock, physical injury, malfunction or damage to the product.)
3. Do not alter or repair this product. If maintenance or repair service is required, please contact your local Qlight contact point. (Failure to follow these instructions may lead to fire, electric shock, or product damage.)
4. Please apply the correct voltage to the product. (Failure to follow these instructions may lead to fire, electric shock, or product damage.)
5. When the product is applied to a condition that may impact lives or property, please make sure to have a double safety device. (Failure to follow this may cause damage to property, fire, electric shock and loss of life.)

⚠ Precautions for Correct Use

Failure to follow the proper instructions may cause damage to property, the product, or malfunction of the product that would void the warranty.

1. Please remove any objects that can interrupt ventilation around the product.
2. Please turn off the power of the product immediately if it fails to operate properly.
3. Carefully wire the product according to each product's specification.
4. Please be careful in preventing chemicals such as thinner, benzene, etc. in contact with the surface of the product.
5. Do not apply excessive force/impact to the product.
6. Failure to follow any of the instructions above may cause malfunction or damage to the product, fire, and electric shock.

Ordering Specifications

QWTDL	-	WS	-	3	-	110/220	-	RAG
[Model number]		[Sound]		[Layer]		[Voltage]		[Color]
I		I		I		I		I
• QWTDL • QWTDLF		• WS-Warning sound • WP-Special warning sound • WM-Melody • WA-Alarm		• 1-1Layer • 2-2Layers • 3-3Layers • 4-4Layers • 5-5Layers		• 12-DC12V • 24-DC24V • 110/220-AC110V-220V		R-Red A-Amber G-Green B-Blue W-White



Please scan the QR code for more detailed product information.

www.qlight.com

Product Specifications

Model number	Layer	Voltage	Certificate	Weight	Color
QWTDL Steady type QWTDLF Steady/ Flashing type	1	DC12V	CE	0.14kg	R-Red
		DC24V		0.14kg	
		AC110V-220V		0.27kg	
	2	DC12V		0.18kg	R-Red G-Green
		DC24V		0.18kg	
		AC110V-220V		0.32kg	
	3	DC12V		0.23kg	R-Red A-Amber G-Green
		DC24V		0.23kg	
		AC110V-220V		0.36kg	
	4	DC12V		0.27kg	R-Red A-Amber G-Green B-Blue
		DC24V		0.27kg	
		AC110V-220V		0.41kg	
	5	DC12V		0.32kg	R-Red A-Amber G-Green B-Blue W-White
		DC24V		0.32kg	
		AC110V-220V		0.45kg	

Type	Built-in sound	Channel	Type of sound
WS	5 Warning Sounds	Ch1 Ch2 Ch3 Ch4 Ch5	Fire.A-ANG(560Hz-1.5kHz) Emergency WA-U(600Hz-1.5kHz) Ambulance PI-PO(450Hz-900Hz) Machinery Fault(820Hz) High Expansion(1kHz)
WP	5 Special Warning Sounds	Ch1 Ch2 Ch3 Ch4 Ch5	Fire.A-ANG(560Hz-1.5kHz) Abandon Alarm(820Hz) Machinery Fault(820Hz) High Expansion(1kHz) 7 Short Pl. / 1 Long(1kHz)
WM	5 Melodies	Ch1 Ch2 Ch3 Ch4 Ch5	Sweet Home For Elise Cuckoo's Waltz Piano Sonata Turkish March
WA	5 Alarms	Ch1 Ch2 Ch3 Ch4 Ch5	Beep Intermittent Door Chime Phone Ring PI.PI.PI Short Tripping Beat

※ Max.built-in volume feature is based on WS-Ch1(Max.85dB at 1m).

※ AC type model has a free-voltage range of AC100V-240V.

※ CE compliant : DC12V, DC24V

• Protection rating : IP54

• Ambient operating temperature : -30°C to +50°C

■ Light source/signal sound current(based on 1 layer)

Voltage	DC12V	DC24V	AC110V~220V
Light source current(1 layer)	0.105A	0.080A	Max.0.035A
Signal sound current	0.200A	0.140A	Max.0.060A

Dimensions

(Unit : mm)

QWTD

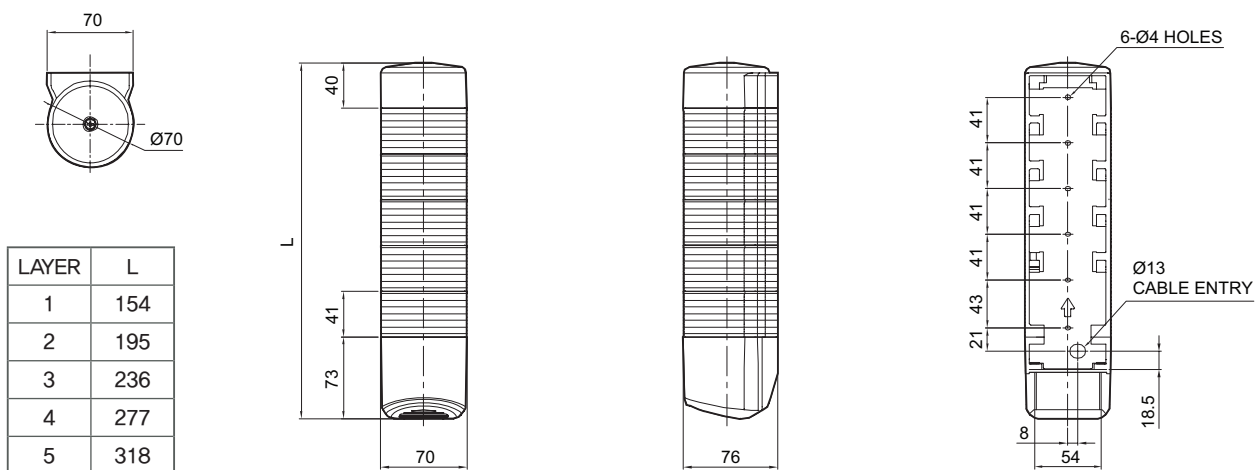

Wiring Instructions

- QWTD series can be wired with either External Contact or transistor.
- For QWTDLF model, user can choose light function between steady and flashing mode through wiring configuration.

QWTDL-DC/AC(Steady Type)

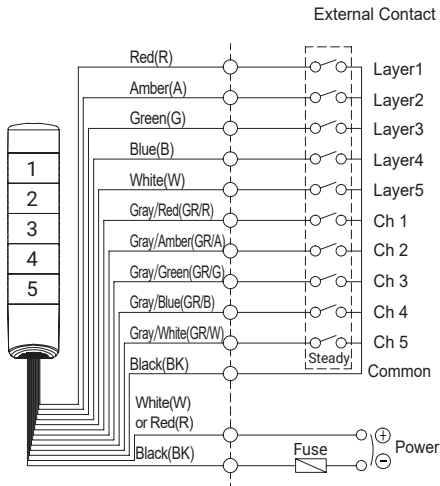

QWTDLF-DC/AC(Steady/Flashing Type)

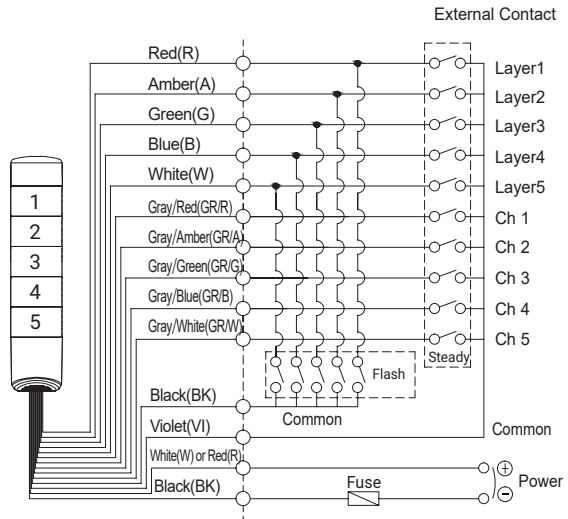

QWTDL-DC/AC(Steady Type)

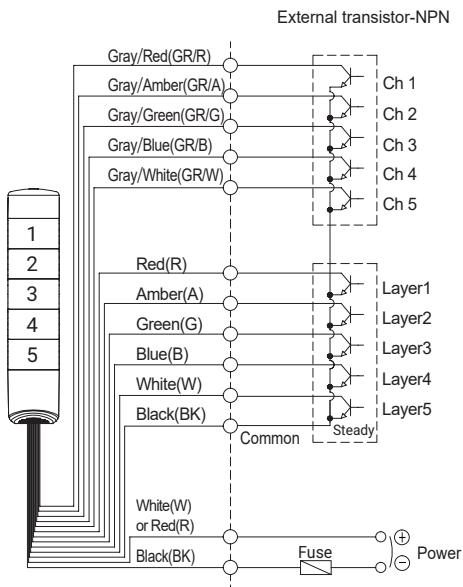

QWTDLF-DC/AC(Steady/Flashing Type)

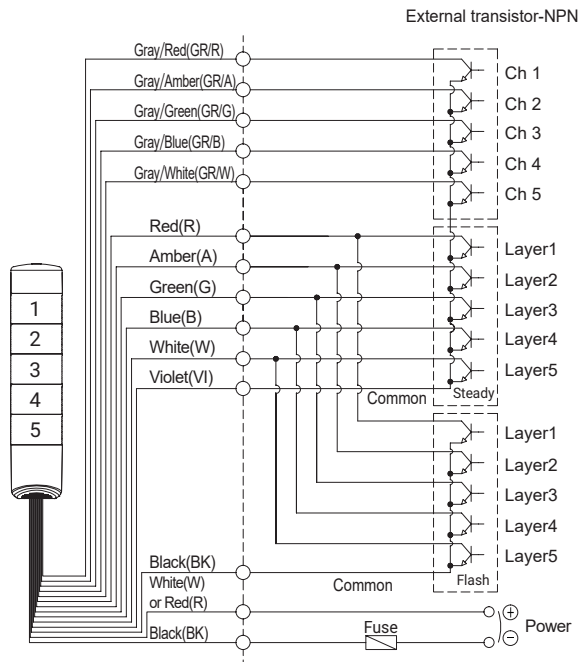

- External power line - UL1015 AWG18(0.75sq) x 2C 400mm
- External signal line - UL1007 AWG22(0.3sq) 400mm

Sound Selection

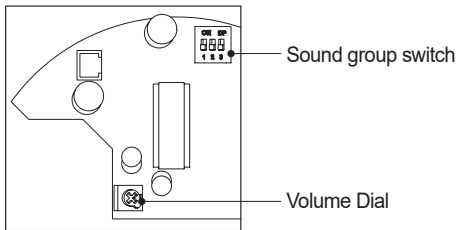

- The standard type product has a tone setting switch and volume control built-in inside the product.
- Select the desired channel using the channel selection switch
- For tone group settings, refer to the website [Customer Support]- [Technical Data] - [Types of Tone and Combination of General Tone products].

■ Sound Type by Group

ON(1) OFF(0)				Sound composition(5Ch)						
No.	1	2	3	Sound Type	Ch1	Ch2	Ch3	Ch4	Ch5	Volume (Max.)
1	0	0	1	WS(5 Warning sounds)	Fire.A-ANG	Emergency WA-U(Yelp)	Ambulance PI-PO(Hi-low)	Machinery Fault	High Expansion	Max.85dB
2	0	1	0	WP(5 special warning sounds)	Fire.A-ANG	Abandon Alarm	Machinery Fault	High Expansion	7 Short PI. / 1 Long	Max.85dB
3	0	1	1	WM(5 melodies)	Sweet Home	For Elise	Cuckoo's Waltz	Piano Sonata	Turkish March	Max.85dB
4	1	0	0	WA(5 alarms)	Beep Intermittent	Door Chime	Phone Ring	PI.PI.PI Short	Tripping Beat	Max.85dB

※ In case of customized WV 5 tone type, there may be difference of volume depending on user's audio file type.

Volume Adjustment

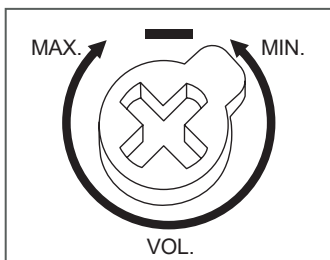

Volume Dial

- The volume output of this product is adjustable.
- Turn the volume dial clockwise to increase the volume, and turn counter clockwise to decrease the volume.
- There will be no sound when the dial is put at MIN.

Parts Definition

■ Sound Selection Switch

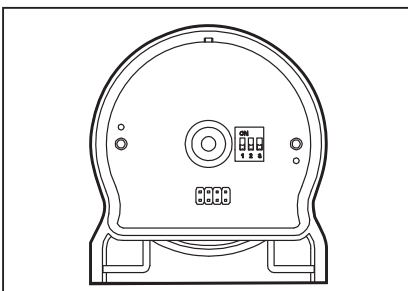

Please refer to page 4 'Sound Selection' section of this manual for detailed instruction.

■ Sound Output Section

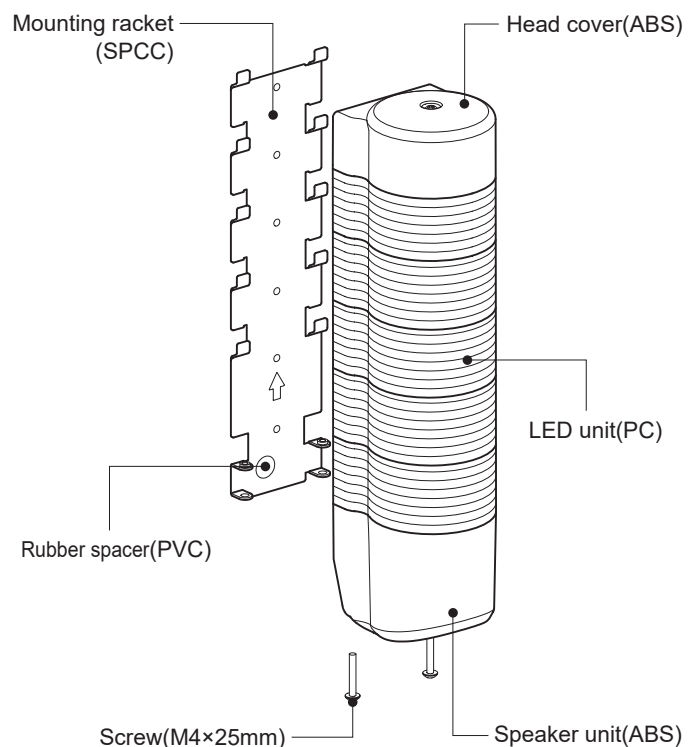
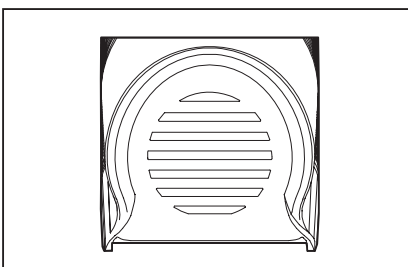

Replacing/ Rearranging LED Lens Units

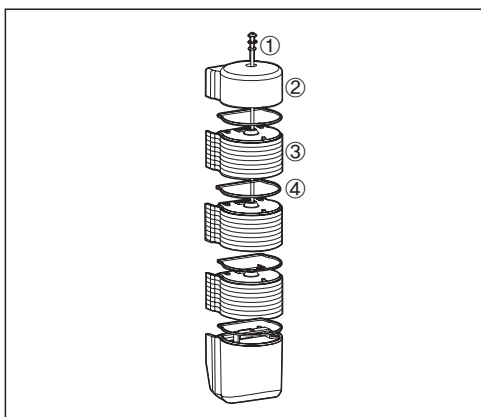

Please ensure the power is off before replacing or rearranging the LED units. Please carefully follow the following instructions.

1. Remove the head cover② by loosening the fixing screw①.
2. Remove the LED unit by pulling it③ upward.
3. Replace or rearrange the LED units.
4. Assemble in the reverse order of removing the LED units, Be careful not to let the rubber packing④ fitted on the top of each unit come off.

Installation

- The user need to install the mounting bracket on to the mounting surface first to fix the product body on to the mounting surface.
- Drill proper mounting holes in accordance with the number of LED lens unit, referring to the installation diagrams below.

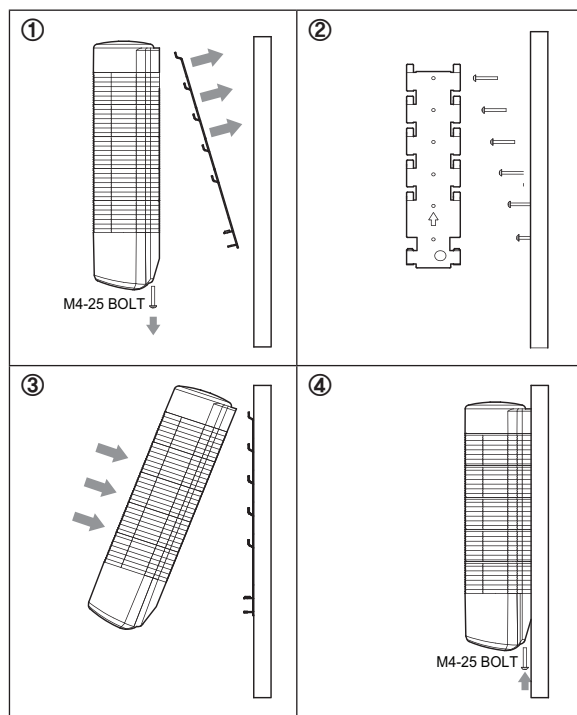
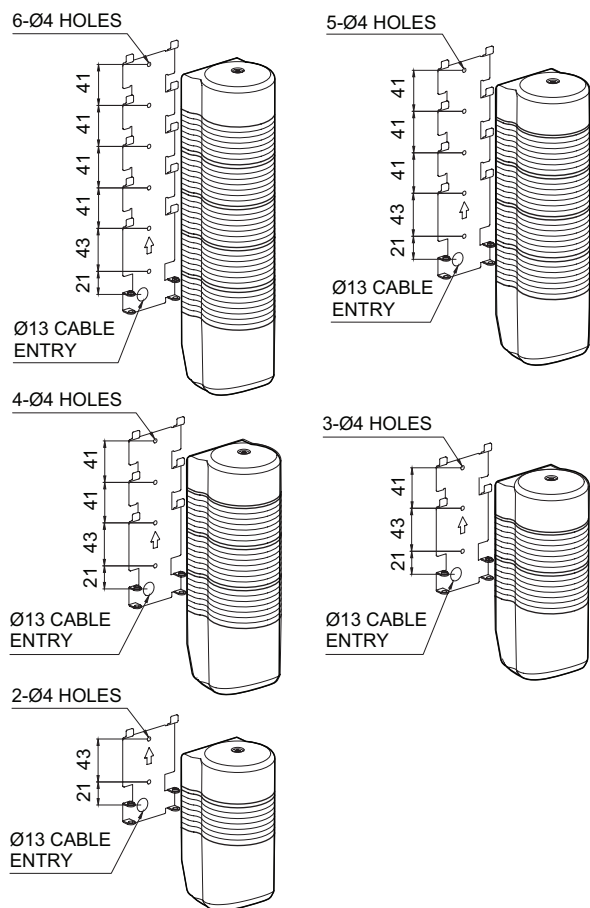

- ① Remove the mounting bracket from the product by removing two M4 screws from the speaker unit.
- ② Mount the mounting bracket to the mounting surface.
- ③ Hook the rear of the head cover to the upper bracket, then push the body against the mounting bracket.
- ④ After tightly attaching the product body to the mounting bracket, tighten the two M4 screws removed in step ① at the bottom of the speaker unit.

Installation Environment and Protection Rating

- This product is designed for indoor use with protection rating of IP54.
- If the product is installed in locations that subject it to excessive dust or water other than the designated IP protection rating indicated(IP54), it may cause malfunction or damage to the product.
- For further information, please visit our website(www.qlight.com).

Product installation direction

- Install the product in accordance with the manual. Otherwise rainwater or moisture may penetrate into the product.

· BEACON/SIGNALING LIGHT

※ For products with a protection rating of less than IPX4, please install it vertically.

Power cord inlet part shall not be facing the sky.

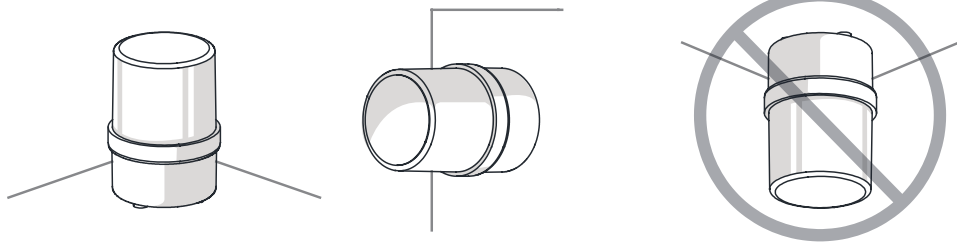

· ELECTRONIC SOUNDER/SIGNAL HORN

Sounder part shall not be facing the sky.

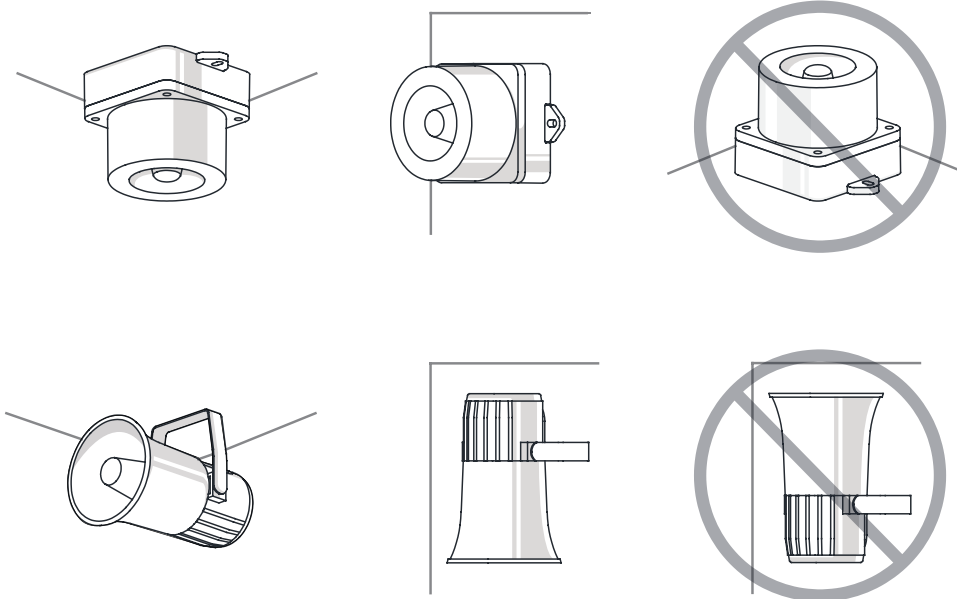

· HEAVY-DUTY & EXPLOSION PROOF SIGNALINGS

Sounder part shall not be facing the sky.

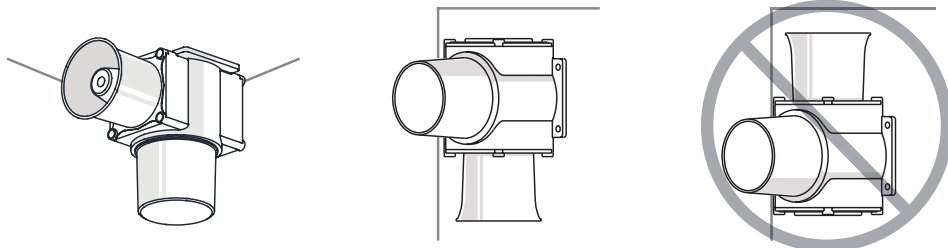

· SIGNAL TOWER LIGHTS

※ For products with a protection rating of less than IPX4, please install it vertically.

Power cord inlet part shall not be facing the sky.

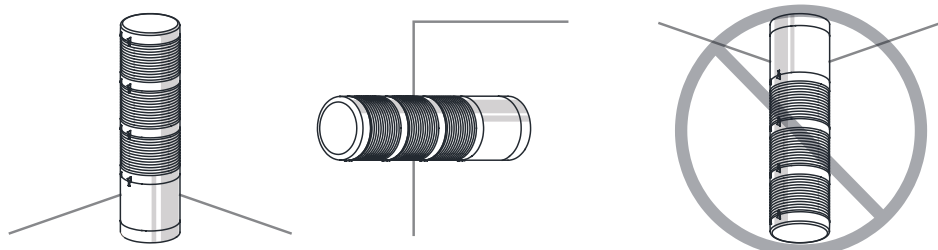



For your safety

Specification and dimensions listed in this catalogue subject to change without notice for product quality improvement.
The newest product information is available on our website.(www.qlight.com)
Please read the instruction manual attached to the product carefully before installation and use.

Qlight Co., Ltd. www.qlight.com | trade@qlight.com

Head Office | Suite #1510, STX-V Tower, 128 Gasan digital 1-ro, Geumcheon-gu, Seoul, Korea

Tel. +82-2-2679-6152(Toll free. +82-80-328-2222) Fax. +82-2-2679-6154

Factory | 185-25, Mukbang-ro, Sangdong-myeon, Gimhae-si, Gyeongsangnamdo, Korea Tel. +82-55-328-1111(Toll free. +82-80-328-1111)

Qlight Overseas Sales Dept | 704 Nakdong-daero, Sasang-gu, Busan, Korea(Eomgung-Dong) Tel : +82-51-620-4100

Qlight Public Relations & Marketing Team Office | 704 Nakdong-daero, Sasang-gu, Busan, Korea(Eomgung-Dong) Tel. +82-51-245-0017

SHANGHAI Qlight Electronic Co., Ltd. www.qlight.com www.qlightcn.com | qlightcn@qlight.com

China Factory/ Shanghai Sales Office | #Room 333 Building B, #11, Lane 450, Zhenda Road, Baoshan District, Shanghai, China

Tel. +86-21-6651-7100 Fax. +86-21-6315-3929

China Factory Site 2 (Qidong) | #33, Haiyan Road, Qidong High-tech Industrial Development Zone, Qidong, Jiangsu Province, China

Tel +86-513-8384-9999 Fax +86-513-8384-9910

Qlightec

Innovation in Alarm & Signal

Product Operation Inquiry / Customer Support +82-51-620-4100

You can expect prompt service if you have exact information such as model name, symptom, telephone number and address.

※ ALL PRODUCT, PRODUCT SPECIFICATIONS AND DATA ARE SUBJECT TO CHANGE WITHOUT NOTICE TO IMPROVE RELIABILITY, FUNCTION OR DESIGN OR OTHERWISE.

Head office : Suite #1510, STX-V Tower, 128 Gasan digital 1-ro, Geumcheon-gu, Seoul, Korea (Postal Code : 08507)

Factory : 185-25, Mukbang-Ro, Sangdong-Myeon, Gimhae-Si, Gyeongsangnam-Do, Korea (Postal Code : 50805)

www.qlight.com

EN - QWTDL - 2403A